

PCB LAYOUT

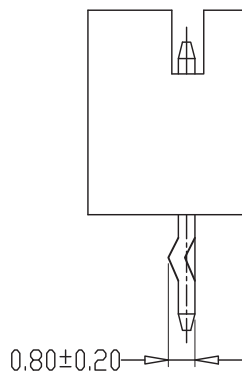

TYPE 3

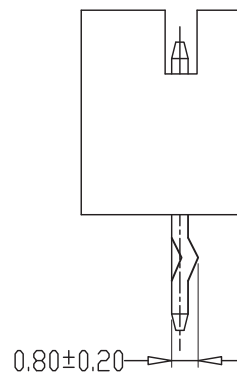

TYPE 4

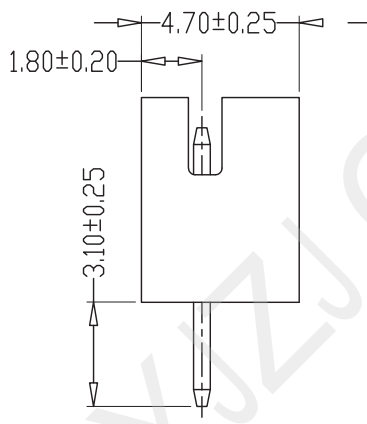

TYPE 1

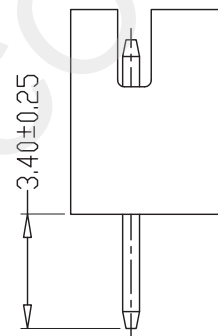

TYPE 2

SPECIFICATIONS

- 1、Current Rating: 2A AC, DC
- 2、Voltage Rating: 250V AC, DC
- 3、Temperatuer Range: -25°C~+85°C
- 4、Contact Resistance: 20mΩ Max
- 5、Insulation Resistance: 1000MΩ Min
- 6、Withstanding Voltang: 800V AC/minute
- 7、Material: Wafer PA66, UL94V-0
PIN Brass Tin-plated

PIN	尺寸 (mm)		
	A	B	C
02A	2.00	6.00	5.00
03A	4.00	8.00	7.00
04A	6.00	10.00	9.00
05A	8.00	12.00	11.00
06A	10.00	14.00	13.00
07A	12.00	16.00	15.00
08A	14.00	18.00	17.00
09A	16.00	20.00	19.00
10A	18.00	22.00	21.00
11A	20.00	24.00	23.00
12A	22.00	26.00	25.00
13A	24.00	28.00	27.00
14A	26.00	30.00	29.00
15A	28.00	32.00	31.00
16A	30.00	34.00	33.00



深圳市华宇创精密电子有限公司

TOLERANCE: X.X ±0.30 X.XX ±0.25 X.XXX ±0.15 X' ±2' X.X' ±0.5'	DRAWN BY : 陈一鸣	DATE : 2014-02-23	PART NAME: PH 直针	
	CHECKED BY : 马跃	DATE : 2014-02-23	PART NO.	HYC15-NA-200G-X
UNIT: mm [inch] SCALE:1:1 SIZE: A4	APPROVED BY : 邱国夷	DATE : 2014-02-23	MOLD NO.	
			DRAW NO:	HYC-2601231606
			SHEET NO.	1 OF 1